

INSTALLATION INSTRUCTIONS

FIELD INSTALLED 0-100% MOTORIZED FRESH AIR DAMPER, DOWNFLOW MODEL 2MD04703224

Step 1:

Check for correct number of parts. See list below:

- 1 ea. - Fresh Air Damper
- 1 ea. - Hood Top
- 2 ea. - Hood Sides
- 1 ea. - Front Hood Panel
- 1 ea. - Divider
- 4 ea. - Filter Channels
- 1 ea. - Bottom Hood Cover
- 4 ea. - 24 $\frac{5}{8}$ " x 23 $\frac{1}{8}$ " x 1" Mist Eliminator Filters
- 1 ea. - Hardware Bag
- 16 ea. - Self Tapping #10 16 x $\frac{1}{2}$ " Screws
- 42 ea. - Type A #10 16 x $\frac{1}{2}$ " Screws
- 4 ea. - Filter Clips
- 10 ft - $\frac{1}{8}$ " x $\frac{1}{2}$ " Gasket

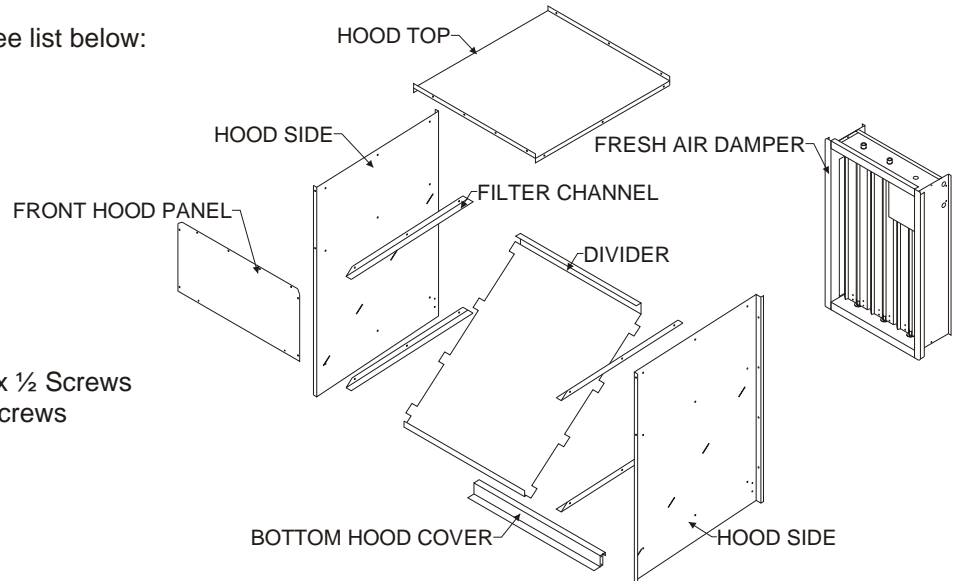

Step 2:

To assemble the fresh air hood the following will be needed.

- 34 ea. - Type A #10 - 16 x $\frac{1}{2}$ " Screws
- 4 ea. - Filter Clips
- 10 ft. - $\frac{1}{8}$ " x $\frac{1}{2}$ " Gasket

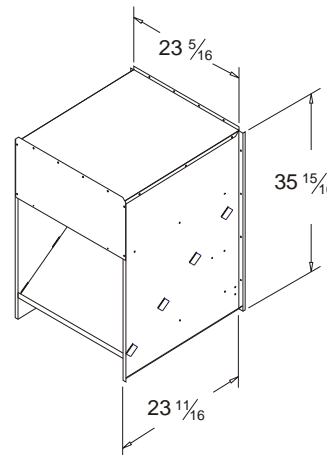

Follow these steps:

- A. Take (2 & 3) and screw through (1) into (2 & 3) using the Type A screws.
- B. Take (4 & 5) and screw through (6) into (4 & 5) using the Type A screws.
- C. Take (7) and put to the inside of (1 & 6) and secure with Type A screws.
- D. Take (8) and place tabs into slots of (1 & 6) and bend tabs down on the outside of (1 & 6).
- E. Take (9) and place flanges with the three holes over (1 & 6) and secure with Type A screws.
- F. Take (10) and secure to (1, 6, 9) with Type A screws.
- G. Take filter clips and screw to (8 & 10) with Type A screws.
- H. Place gasket on the back flanges of (1, 6, 7, 9)
- I. Install filters in the hood and fasten clips to hold in place.

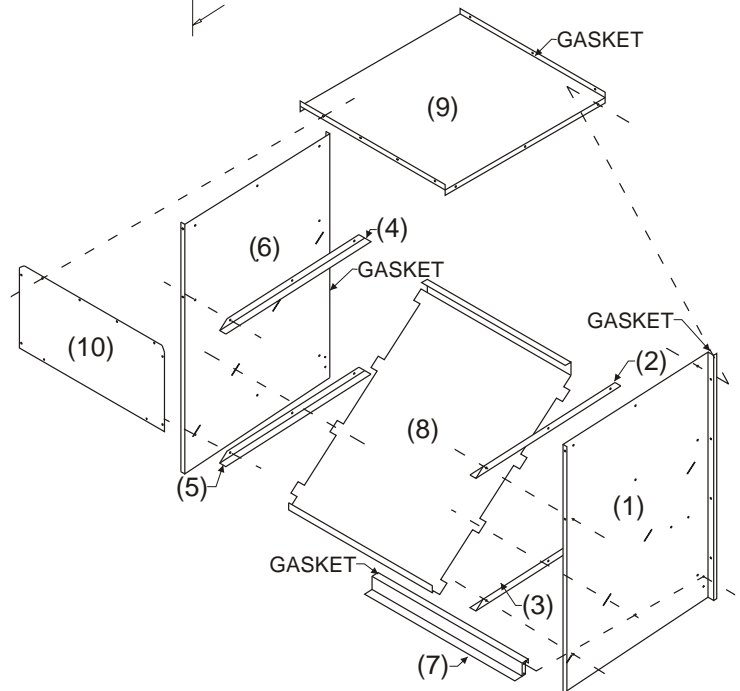

INSTALLATION INSTRUCTIONS

FIELD INSTALLED
0-100% MOTORIZED FRESH AIR DAMPER, DOWNFLOW
MODEL 2MD04703224



MOTOR TO TOP
OUTSIDE AIR DAMPER
UNIT END PANELS REMOVED

HOLE TO ATTACH FRESH AIR DAMPER

Step 3:

Remove the return air duct cover and the top rear panel from the end of the unit as shown. Keep screws to use later in Step 6.

Step 4:

Install the fresh air damper into the horizontal return air duct opening as shown. Using the self tapping #10 - 16 x 1/2 screws provided secure to duct connection (two on each side).

Step 5:

Plug the 0-100% motorized fresh air damper cable into the unit as shown. The "jumper" plug that ships with the unit should be removed and saved in the control compartment for future needs.



Step 6:

Reinstall the top rear panel which was removed in Step 3 of the unit using the remaining screws also removed in Step 3.

Step 7:

Install the assembled Fresh Air Hood as shown using #10 - 16 x 1/2 self tapping screws. Place fresh air hood approximately 3" down from top of the unit and flush with flange on hood side.



<p>E# = WIRE END DESIGNATION</p> <p>E2 STUD #6 18 Ga. Wire</p> <p>E3 Female ¼ Quick Disc.</p> <p>E4 Male ¼ Quick Disc. Insul</p> <p>E6 Wire Nut Size 73B</p> <p style="text-align: center;">HARNESS ENDS AT (P7) FRESH AIR PLUG</p>	<p style="text-align: center;">COMPONENT CODE</p> <p>Economizer</p> <p>S7 Unit Plug (Male)</p> <p>P7 Fresh Air Plug (Female)</p> <p>M8405A Damper Actuator 24V</p>	<p style="text-align: center;">WIRE COLOR CODE</p> <table border="0"> <tr> <td>BLK</td> <td>Black</td> <td>BRN</td> <td>Brown</td> </tr> <tr> <td>GRA</td> <td>Gray</td> <td>YEL</td> <td>Yellow</td> </tr> </table>	BLK	Black	BRN	Brown	GRA	Gray	YEL	Yellow
BLK	Black	BRN	Brown							
GRA	Gray	YEL	Yellow							

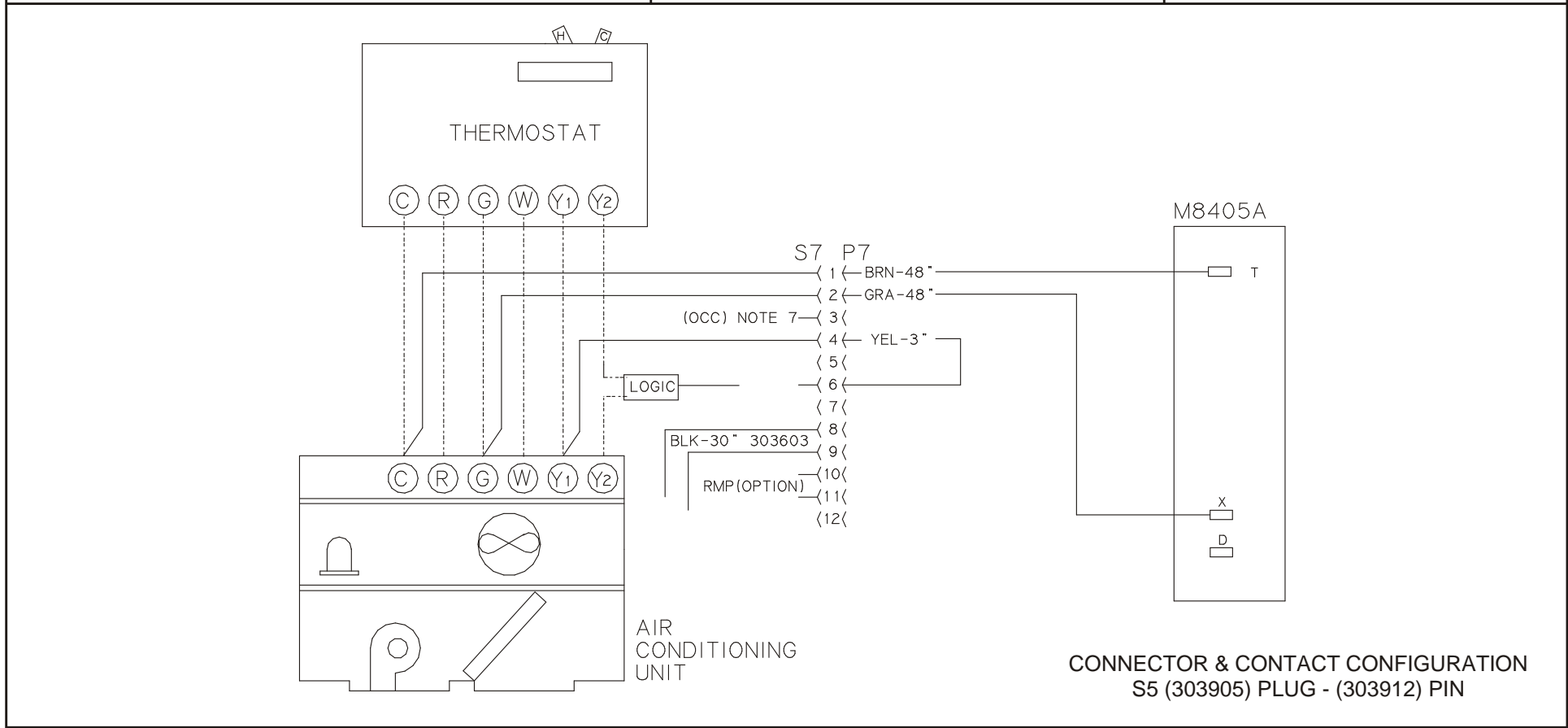

Notes:

- Unit wiring shown as reference only. Check unit wiring for actual unit wiring.
- Y2 must be energized for the compressor to operate.

0-100% Motorized Fresh Air Damper 2MD04703224	
Rooftop Systems, Inc. 2405 McIver Lane Carrollton, Texas 75006 Phone (972) 247-7447 Fax (972) 243-0940	Date: September 11, 2009
	Supersedes:
	Drawn by:
	Unit # 80-302-29CB
Diagram# 30229CBW	